

# How to access your child's online learning

## Bug Club

activelearnprimary.co.uk

You will be taken to a screen like this:

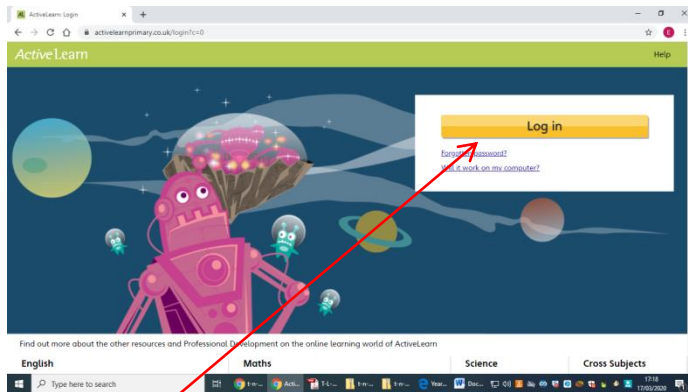

Click 'log in'

A screenshot of the 'Sign in' page. It has a white background with a blue header. The page contains three input fields: 'Username' (with a blue icon of a person), 'Password' (with a blue icon of a lock), and 'School code (Primary schools only)'. The 'Username' field contains 'y.310', the 'Password' field contains '\*\*\*\*\*', and the 'School code' field contains 'elmg'. A yellow 'Sign in' button is at the bottom. A red arrow points from the 'Log in' button on the previous page to the 'Sign in' button.

Your child's LGFL user name.

Their password.

The school code is **elmg**.

Click on 'my stuff'

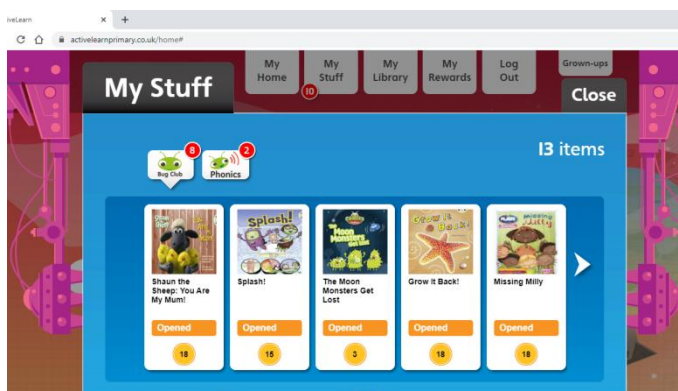

My Maths

mymaths.co.uk

You will be taken to a screen like this:

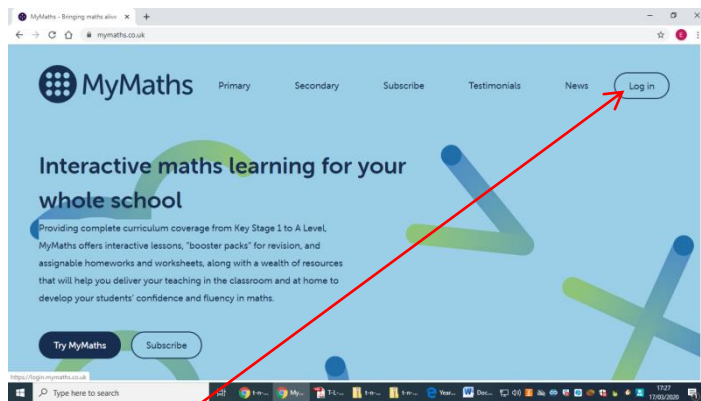

Click 'log in'

The screenshot shows the MyMaths login form. It has two input fields: 'School username' and 'School password'. The 'School username' field contains the text 'elmgrove'. Below the password field is a 'Log in' button and a help icon (a question mark in a circle).

elmgrove  
shape

The screenshot shows the MyMaths login form with annotations. The 'My portal username' field is annotated with '4 numbers' and the 'My portal password' field is annotated with '3 letters'. There is a 'Log in' button and a help icon (a question mark in a circle).

4 numbers  
3 letters

My homework:

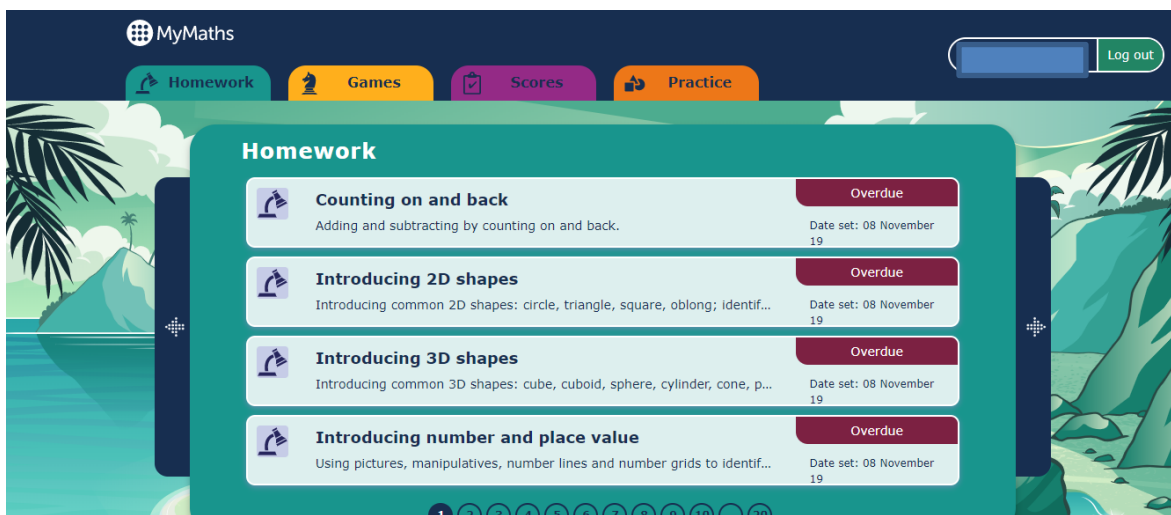

Purple Mash

Type 'LGFL resources' into Google.

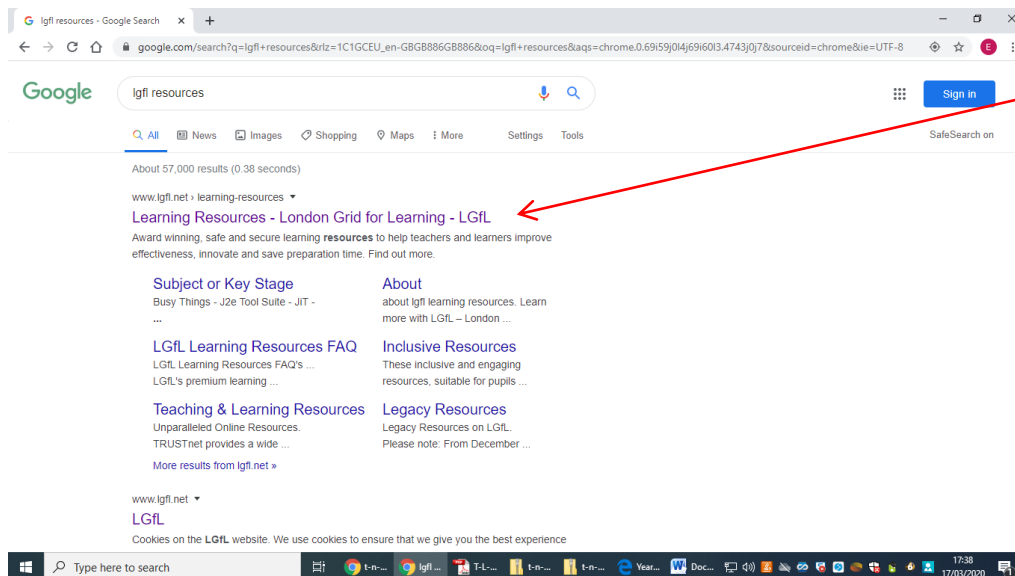

Click on the first link.

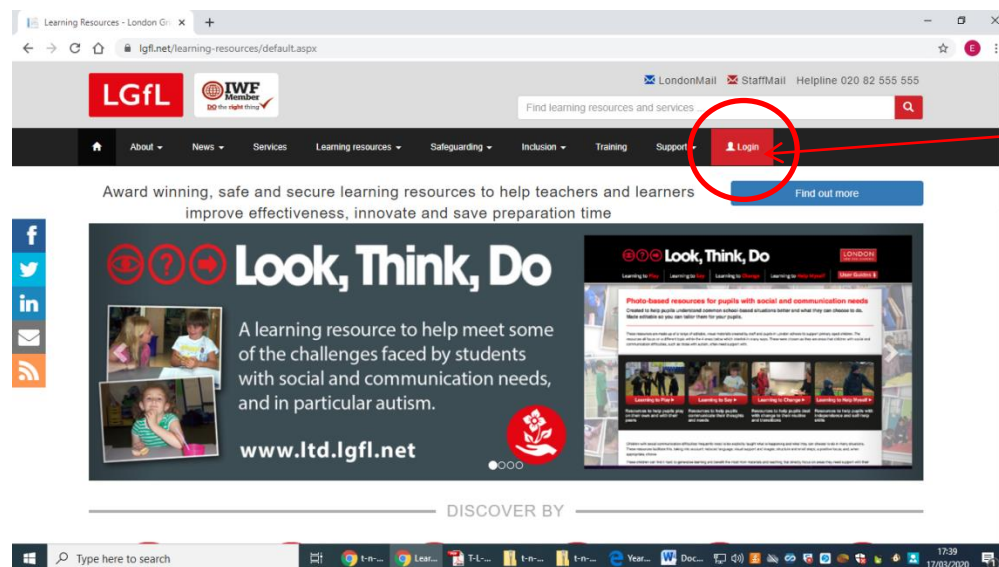

Click on 'log in'.

LGfL THE NATIONAL GRID FOR LEARNING

You have requested access to the LGfL website.

Please enter your USO username and password, then click the Login button.

USO username: 310

password: \*\*\*\*\*

Login

If you are using a public or shared computer, please ensure that you log out and close all browser tabs so the next user is unable to access your account.  
Note for system administrators: do not enable any browser features that re-open recently-viewed web pages at startup.

Your child's LGFL username.

Your child's password.

You will be taken to this page.

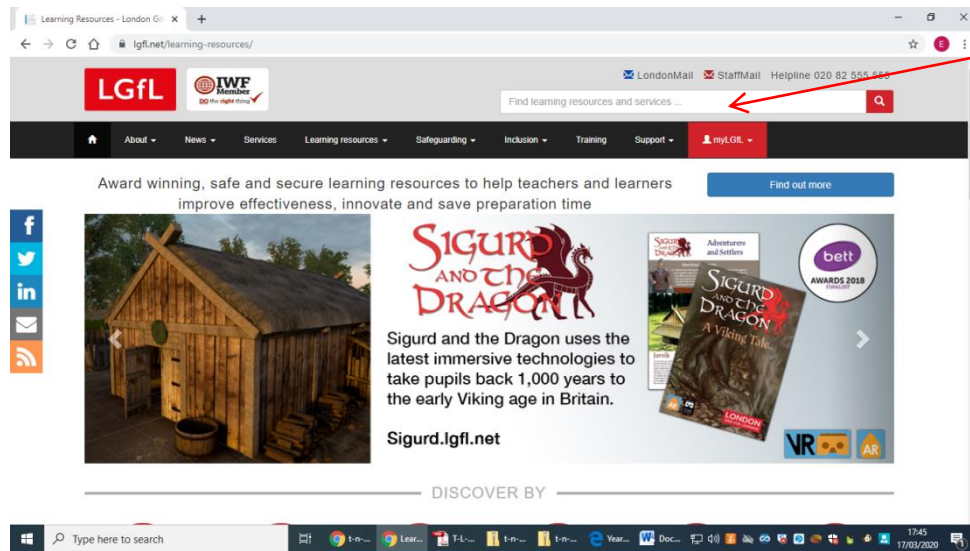

In the search box, type in 'purple mash'.

Click on the first result.

